



Fonderie Sime S.p.A.

Via Garbo, 27 - 37045 Legnago (VR) - Tel. +39 0442 631111 - www.sime.it - PEC fonderiesime@legalmail.it - SDI DH57HLI

Registro Imprese Verona C.F./Partita IVA IT01275930236 - R.E.A. VR 171357 - N Mecc. VR 014435

Capitale sociale int. versato 5.521.200,00 - Societ controllata da Sime S.p.A.

8053311 CALD.GAS MET.GRIG. RS151 Mk II

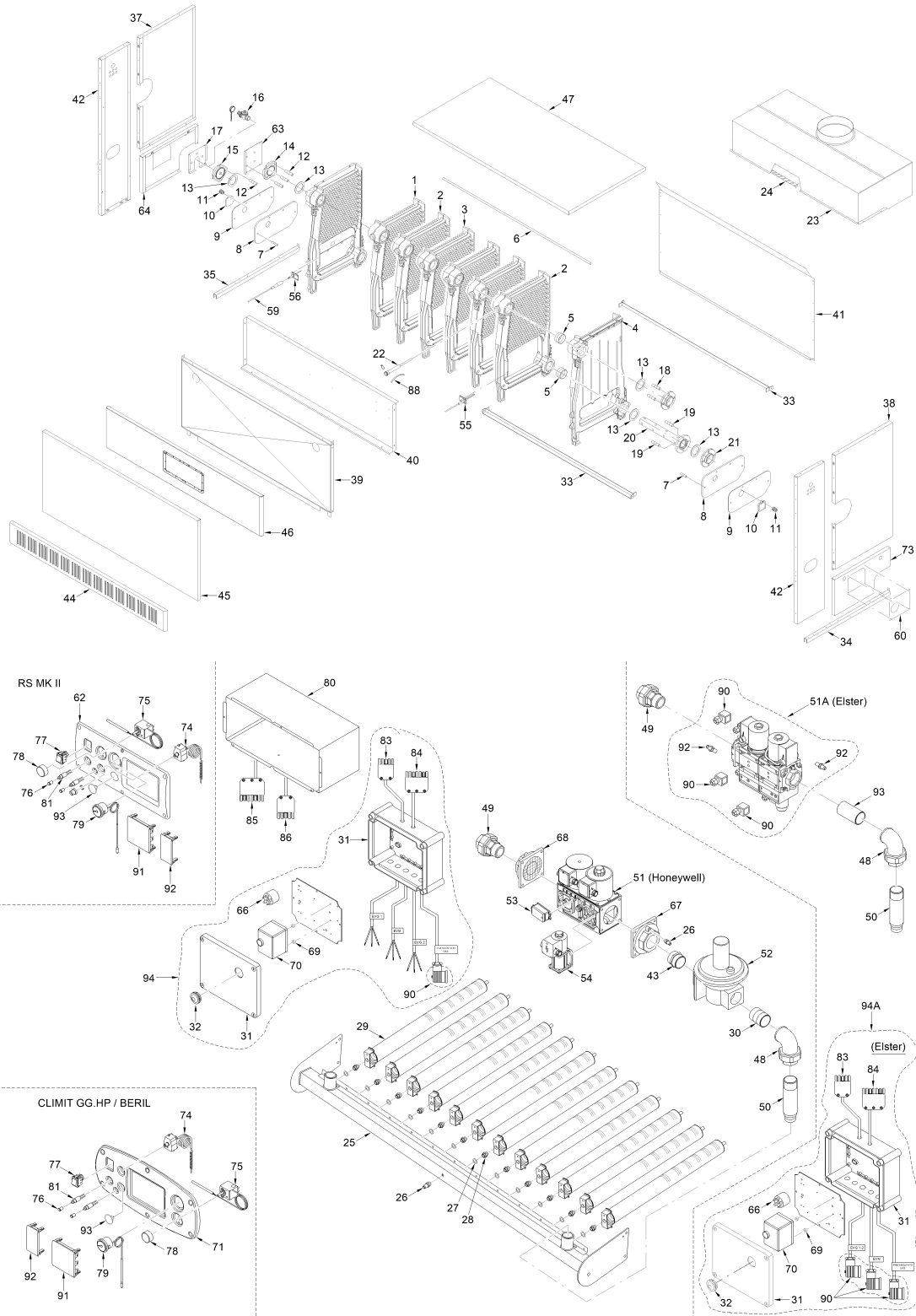

The exploded diagram is common to several finished products. The spare parts related to the selected code are only those listed below.

IMPORTANT: The use of non-original spare parts will void the warranty and may compromise the safety of the product.

| Position | Code | Description | Note | Advised parts |
|----------|---------|---------------------------------|------|---------------|
| 001 | 6096512 | Left hand end section | | |
| 002 | 6096614 | Intermediate section with drill | | |

| | | | | |
|------|---------|---------------------------------|-----------------------|---|
| 003 | 6096613 | Intermediate section | | |
| 004 | 6096712 | Right hand end section | | |
| 005 | 6000403 | Push nipple 2-1/2" | | |
| 006A | 6000539 | Tie-rod M14x842 | | |
| 007 | 6000609 | Stud M8x34 | | |
| 008 | 6105710 | Combustion chamber door insulat | | |
| 009 | 6105801 | Combustion chamber door | | |
| 010 | 6037601 | Window | | |
| 011 | 2050000 | Spring TDM | | |
| 012 | 6000608 | Stud M12x40 | | |
| 013 | 2030208 | Piracriten gasket Ø 65x95x2 | | |
| 014 | 6105102 | Blank flange F.12/T | | |
| 015 | 6046700 | Flange holding drain cock | | |
| 016 | 6020701 | Drain cock 3/4" | | |
| 017 | 6182005 | Casing lower hub panel | | |
| 018 | 6000606 | Stud M12x50 | | |
| 019 | 6000612 | Stud M12x60 | | |
| 020 | 6106100 | Water distributor | | |
| 021 | 6192400 | Flange 2" | | |
| 022 | 5004200 | Bulb holder 1/2" L=190 | | |
| 023A | 5096703 | Smoke chamber/down draught-dive | | |
| 024 | 1232400 | Sealing rope Ø 15 L=1,423 mt | | |
| 025A | 6104823 | Burner manifold | | |
| 026 | 6023100 | Pressure test nipple Ø 1/8" | TO SN 5412330426 | |
| 027 | 6022003 | Aluminium washer Ø 14 | | |
| 028 | 6105001 | Nozzle Ø 4,30 M14 | MET | |
| 028A | 6105003 | Nozzle Ø 2,50 M14 | GPL | |
| 029 | 6095100 | Burner bar type 109/10 L=561 | | |
| 030 | 6106807 | Pipe extension L=60 | TO SN 5412330426 | |
| 031 | 6002707 | Junction box | | |
| 032 | 6266401 | Plastic plug | | |
| 033A | 6105553 | Frame, front and rear part | | |
| 034 | 6105301 | Frame, right hand side part | | |
| 035 | 6105401 | Frame, left hand side part | | |
| 036 | 2003000 | Pin M5 Zn | | |
| 037 | 6181605 | Casing L.H. side rear upper pan | | |
| 038 | 6181505 | Casing R.H. side rear upper pan | | |
| 039A | 6122691 | Casing lower inner panel | | |
| 040A | 6122791 | Casing upper inner panel | | |
| 041A | 6122812 | Casing rear panel | | |
| 042 | 6123052 | Casing side front panel | | |
| 043 | 2040202 | Nipple 1 1/2" | TO SN 5412330426 | |
| 044A | 6296251 | Casing front lower panel | | |
| 045A | 6296351 | Casing front central panel | | |
| 046A | 6296651 | Casing front upper panel | | |
| 047A | 6301061 | Casing top cover | | |
| 048 | 2040002 | Union elbow F.F. 1-1/2" | | |
| 049 | 2040704 | Union 1-1/2" MF | | |
| 050 | 6083402 | Pipe reducer 1" | | |
| 051 | 6107401 | Gas valve | TO SN 5412330426 | A |
| 051A | 6107403 | Gas valve | FROM SN 5412330427 | A |
| 052 | 6291688 | Gas pressure regulator | TO SN 5412330426 | A |
| 053 | 6043102 | Gas pressure switch | TO SN 5412330426 | A |
| 054 | 6107402 | By-pass gas valve | TO SN 5412330426 | A |
| 055 | 6221613 | Ignition electrode c/w resistan | | A |
| 056 | 6221605 | Ionisation electrode | | A |
| 057 | 6000623 | Stud M5x15 Zn | | |
| 059 | 6186515 | Ionisation electrode cable | | |
| 060 | 6182105 | Casing pilot burner panel | | |
| 061 | 6222600 | Combustion chamber fixing plate | | |
| 062 | 6211011 | Control panel | | |
| 063 | 6181905 | Casing upper hub panel | | |
| 064 | 6181805 | Casing L.H. side rear lower pan | | |
| 066 | 6266901 | Anti-jamming filter | | A |
| 067 | 6105158 | Flange | TO SN 5412330426 | |
| 068 | 6105157 | Flange + filter | TO SN 5412330426 | |
| 069 | 2213202 | Space Ø 10 for control box | | |
| 070 | 6178822 | Control box BRAHMA SM 191.2 | | |
| 073 | 6181705 | Casing R.H. side rear lower pan | | |
| 074 | 6001400 | H.L. stat 100°C | | A |
| 075 | 6159300 | Adjustable boiler stat TRZ | | A |

| | | | |
|------|---------|---------------------------------|-----------------------|
| 076 | 6044041 | Red gem Ø 10 | |
| 077 | 6013501 | Switch with warning light | |
| 078 | 6240103 | Handle Ø 35 | |
| 079 | 6146003 | Thermometer 0-120°C | |
| 080 | 6253211 | Control panel cover | |
| 081 | 6044016 | Signal lamp | |
| 083 | 6202116 | 5 pole socket with cable | |
| 084 | 6202115 | 7 pole socket with cable | |
| 085 | 6202113 | 7 pole plug with cable | |
| 086 | 6202114 | 5 pole plug with cable | |
| 087 | 2015000 | Spring clip | |
| 088 | 2051000 | Contact spring | |
| 090 | 6245386 | Cable connector | |
| 092 | 6332722 | Pressure test taking | FROM SN 5412330427 |
| 093 | 6106804 | Pipe extension L=90 | FROM SN 5412330427 |
| 094 | 5158909 | Control panel | TO SN 5412330426 |
| 094A | 5158910 | Control panel | FROM SN 5412330427 |
| | 6259501 | Air/Smoke test pressure point | |
| | 5158909 | Control panel | TO SN 5412330426 |
| | 6239700 | AR1 phase-phase transformer | |
| | 6233502 | Fuse T 5A for control box CM 19 | |
| | 6272602 | Connection kit for RVA43 progra | |
| | 6050900 | Set boiler assembling tools | |
| | 5114600 | Complete cast iron boiler block | |
| | 5097908 | Complete casing | |
| | 5191604 | Complete control panel | TO SN 5412330426 |
| | 5191605 | Complete control panel | FROM SN 5412330427 |
| | 6253401 | Fuse holder Ø5x20 | |
| | 5113700 | Conversion kit to the L.P.G. | |

A = Spare parts for minimum fittings